

HEALTH CARE



From local NHS Trust the quality of our services installations have enabled us to successfully undertake numerous projects within the healthcare sector, which require detailed understanding of Health Technical Memoranda (HTMs)



ANTELOPE HOUSE, ROYAL SOUTH HANTS HOSPITAL, SOUTHAMPTON

Project Value: £4,260,000

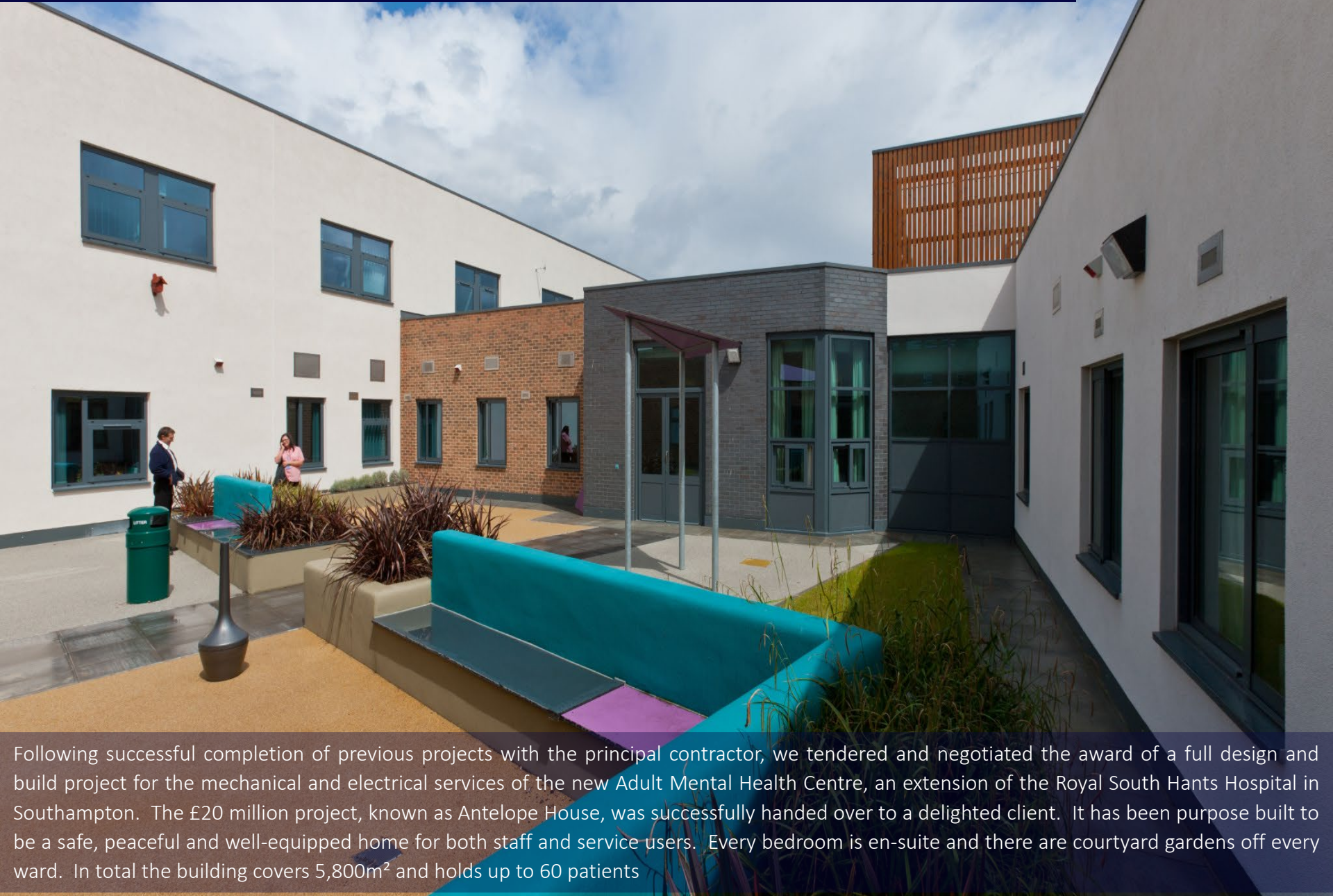

Following successful completion of previous projects with the principal contractor, we tendered and negotiated the award of a full design and build project for the mechanical and electrical services of the new Adult Mental Health Centre, an extension of the Royal South Hants Hospital in Southampton. The £20 million project, known as Antelope House, was successfully handed over to a delighted client. It has been purpose built to be a safe, peaceful and well-equipped home for both staff and service users. Every bedroom is en-suite and there are courtyard gardens off every ward. In total the building covers 5,800m² and holds up to 60 patients

ADELAIDE HEALTH CENTRE, SOUTHAMPTON

Project Value: £2,162,000



Western Primary Care Delivery Centre is a three-storey walk-in Health and Day Care Centre which provides facilities such as physiotherapy, x-ray and minor operations. We carried out the design and build and complete mechanical and electrical services, which included UPS system, small power and lighting, panic alarm system, VRV system, heating and ventilation system, domestic water services and soil and waste services

OAK PARK COMMUNITY CLINIC, PORTSMOUTH

Project Value: £688,714



Extension and refurbishment of an existing Community Clinic, providing a new children's wing, physiotherapy and x-ray facilities. We were awarded the project in two stages; Stage 1 to undertake the full design of the mechanical and electrical services, acting as the Client's services Consultant to design and coordinate the extension of the existing mechanical and electrical services. Stage 2 to carry out the construction and installation of the refurbished/extended services and new services to suit the Clinic's requirements all to HBN and HTM requirements

DIAGNOSTIC TREATMENT CENTRE – WINCHESTER HOSPITAL

Project Value: £2,000,000



A new build project which we installed the mechanical services; DX air conditioning systems, heat recovery supply and extract ventilation, ultraclean theatre canopies, pneumatic tube installation, domestic services, above ground drainage, building management control system, medical gases installation, dry riser installations, sanitaryware installations, reverse osmosis system installations to the Diagnostic Treatment Centre

SOMERSTOWN COMMUNITY HUB, PORTSMOUTH

Project Value: £2,484,027



The building comprised of a two-storey Hub which includes a Community Centre, a Youth Centre, a Primary Care Trust and Dental Surgery and a Local Housing Office and is built across Winston Churchill Avenue. The Community Centre has a number of function rooms, a sports hall and a curved fully glazed double height community lounge at its centre. The installation consisted of new incoming services, gas fired LTHW, VRF cooling, ventilation, BMS, air handling units, syphonic rainwater system, power, lighting, fire alarm, security, data and access systems

WOODHAVEN, TOTTON, SOUTHAMPTON

Project Value: £1,100,000



This building provides a comforting holistic environment for adult patients to receive treatment and therapy for acute mental health support. The architectural form optimises the penetration of sunlight to all activity areas producing a range of views onto the surrounding landscape and courtyards. A double height foyer provides a dynamic and stimulating setting for the communal dining and recreational activities. Building services installation comprise of: LPHW heating services, gas installation and testing, chilled water services, mechanical supply and extract ventilation, installation of sanitaryware, plumbing services, hot water distribution systems, boosted cold water mains, public health services, BMS controls and wiring, nurse call services, lighting and power services, emergency lighting, mains power distribution, fire alarm services

BURRELL WING, ROYAL HAMPSHIRE COUNTY HOSPITAL, WINCHESTER

Project Value: £1,343,406



An existing multi-storey, multipurpose Hospital building located within the Royal Hampshire County Hospital, Winchester. The project involved the refurbishment of part floors over two storeys of the building, which form Burrell Wing. Work required the removal of existing mechanical and electrical systems, with extensive upgrades and new mechanical and electrical services throughout, including main plant whilst maintaining supplies serving the remainder of the occupied building

THE MEADOWS CENTRE FOR HEALTH, HOUNSLOW

Project Value: £735,000



The construction of a two-storey Community Doctors Surgery incorporating various treatment rooms including minor surgery, offices, reception area, staff and patient toilet/shower facilities, lift installation and plantroom. The facility also included an independently run Pharmacy. The electrical installation consisted of lighting and small power wiring, data installation, security and access control systems, disabled alarm systems, nurse call systems, TV and lightning protection. The mechanical installation consisted of air conditioning and refrigeration installations, LTHW water systems, domestic water services, above ground drainage, automatic controls and the installation of air source heat pumps

SIGNATURE / SUNRISE LIVING

7no Properties Total Value: £7,150,000

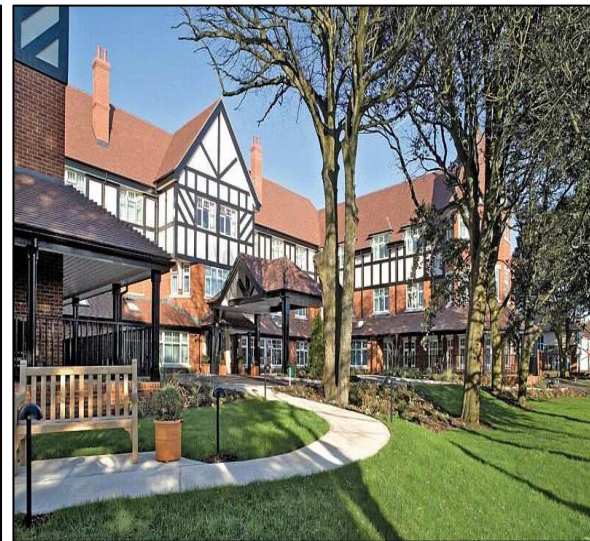

SIGNATURE / SUNRISE LIVING

Typically a two storey assisted living care home, incorporating approximately 80 to 90 resident bedrooms with staff welfare, bistro, parlour, kitchen and lounge areas

Although our responsibility was for the mechanical services, we also took on the responsibility as lead co-ordinators incorporating electrical and fire alarm installations into the drawing design

Effectively a large residential property, our installation included residents bathroom ventilation, all domestic services to bathrooms and residents kitchenettes, commercial kitchen ventilation and domestics. In addition to the above, the installation of a two pipe reverse return radiator heating circuit and various air conditioning units to back of house areas were provided

Packaged plantrooms were installed together with centralised ventilation plant

Project: Mechanical services together with co-ordination of the electrical installation

Project Values:	Virginia Waters	£750,000
	Purley	£1,200,000
	Fleet	£800,000
	Bournemouth	£1,000,000
	Guildford	£1,050,000
	Esher	£1,100,000
	Chorleywood	£1,250,000

Overall Framework Total: £7,150,000

Design: Full mechanical services design and build

Programme: 28 weeks to 36 weeks



WITH A SPECIAL NEIGHBOURHOOD
FOR THE MEMORY IMPAIRED

SHAW HEALTHCARE

10no Properties Total Value: £5,426,000



We have completed ten new build assisted living nursing homes. These 2-3 storey buildings vary in size from 60 to 90 bedrooms with various ancillary rooms. The homes are of timber frame construction with tiled roofs. With the priority to have concealed services, the heating and domestic pipework throughout the building has been installed through the timber frame using speedfit pipework, with soil and vent pipework concealed within purpose made boxings

Project: Mechanical services together with co-ordination of the electrical installation

Project Values:	Deerswood, Crawley	£670,000
	Forest View, Burgess Hill	£480,000
	Elizabeth House, Bognor	£475,000
	Mill River Lodge, Horsham	£695,000
	Pulborough	£480,000
	Burleys Wood, Crawley	£540,000
	Littlecote, Petworth	£555,000
	Southlands, Shoreham-by-Sea	£490,000
	Yapton	£467,000
	Steyning	£574,000

Overall Framework Total: £5,426,000

Design: Full mechanical services design and build

Programme: 29 to 32 weeks

SUNNYSIDE MEDICAL CENTRE, PORTSMOUTH
Project Value: £395,000

[illegible]

Design and build, mechanical and electrical services to a new Doctors Surgery, Fitness Suite and Primary Care Trust

Poole Hospital, NHS Trust, Linac Suites
Project Value: £340,000



Mechanical services and controls to two new radiation machines and modifications to one existing radiation unit

ST GEORGE'S HOSPITAL, LONDON - JENNER WING

Project Value: £1,015,000



This project comprised of the second phase of a refurbishment to the second-floor laboratories and offices. This included the provision of new roof mounted chillers and AHUs together with the appropriate connections to the existing services. The pre-designed project consisted of the supply, installation, testing and commissioning of new LTHW, CHW and primary and secondary ventilation systems serving fan coil units throughout the second floor. Also installed are domestic, public health services and laboratory wastes

ROYAL FREE HOSPITAL, KIDNEY CARE CENTRE, TOTTENHAM HALE

Project Value: £1,500,000



The project consisted of a three-storey Dialysis Unit for the Royal Free Hospital. The location is unusual for the Royal Free Hospital as it is their first satellite unit and is positioned within a residential complex below a block of Flats. The unit has the capability to provide dialysis for up to 39 patients along with a patient self-dialysis training facility. Also contained within the property are numerous consulting rooms, examination rooms, staffing provisions and basement plant rooms. The design and build mechanical and electrical package not only included all the standard mechanical and electrical systems, but also specialist systems such as medical gas, reverse osmosis, water conditioning, nurse call, panic alarms, district heating and air conditioning leak detection

HIGHGATE MENTAL HEALTH CENTRE, ISLINGTON

Project Value: £210,000



Highgate Mental Health Centre

The Highgate Mental Health Unit contract was the refurbishment of an existing Hospital Ward from a Day Hospital into a sixteen bed, low secure unit. We were contracted to install the fully designed mechanical services, which include supply and extract ventilation ductwork, complete with addressable fire and smoke dampers, underfloor heating and domestic services to the en-suite bathrooms, with comfort cooling D/X split systems to selected rooms

WEXHAM PARK HOSPITAL, BUILDING 22, WARDS 10 AND 11, MIDDLESEX

Project Value: £1,174,000



Refurbishment of two floors of an existing three-storey building that holds the DSU (Day Support Unit) on the Ground Floor, hospital security and central hospital telephone services, along with senior nursing staff offices on the Third Floor. The project was a pre-designed project of two new surgical Wards; Wards 10 and 11 comprising of a wide range of mechanical and electrical services, and a new roof top plantroom to enable the Wards to be serviced independently

WEXHAM PARK HOSPITAL, NEW SURGICAL BUILDING

Project Value: £1,200,000



This new purpose-built, two-storey Surgical Facility building includes three ultra clean operating theatres and five general theatres and sundry areas and offices. The mechanical services installed comprise of LPHW heating services, gas installation, chilled water services, refrigeration pipework, ultra clean canopies, supply and extract ventilation including 8no air handling units, installation of sanitaryware, plumbing services, heat recovery services, hot water distribution systems, boosted cold water mains, public health services, medical gas services, ultra-sonic humidification, water purification services, BMS controls and wiring, acoustic treatment, nurse call services, fire alarm services interface, testing and commissioning

OUR
MEP Co.